

# PAPI

## Precision Approach Path Indicator



### COMPLIANT WITH:

FAA AC150/5345-28, L-880 and L-881  
FAA-E-2756  
ICAO - Annex 14  
USAF - AFJMAN 32-1076  
US ARMY – TM5-811-5  
NATO - STANAG 3316  
ASCC - AIR STD 65/35

### GENERAL DESCRIPTION

The Multi Electric 3<sup>rd</sup> Generation PAPI System consists of a three lamp Light Housing Assembly as the main component. Additional components include Power and Control Unit, Series Circuit Lamp Shorting Devices with integral Tilt Switch and Aiming Instrument Set.

### FEATURES CHECKOFF

- ✓ **Low Power Consumption** – The Multi Electric PAPI is a low power consumption, energy efficient system. Each Lamp Housing Assembly draws approximately 300Watts as apposed to others 400 to 600 Watt consumption.
- ✓ **Physical Size** –The size and weight of the Multi Electric PAPI Lamp Housings is up to 30% less than other systems.
- ✓ **Tool-Less Maintenance** – Most routine service components can be changed without the use of hand tools.
- ✓ **Universal Mounting** – The Lamp Housing Assembly can be mounted on wide range of 3 leg mounting patterns. Standard mounting is on a 22" across the front and 16" front to back. Four additional mounting configurations are available for retrofit on most 3-leg PAPI existing foundations.
- ✓ **Experience** – Support of one of the oldest and most experienced companies in the United States for approach lighting systems.

# Multi

ELECTRIC

*The Quality Approach*

## ORDERING INFORMATION

Basic PAPI System:

5900-2 X X - XX

Type: L-880 - 0  
L-881 - 1

Style: A - Voltage Powered - 0  
B - Series Circuit - 1

Option: No-Shorting Device, Style B - 10  
Night Sentinel, Style A (series circuit control) - 20  
Long Mount (28" Tee Bar) - 01

Example:

- 1) 4 LHA L-880 Voltage Powered PAPI on standard mount — 5900-200
- 2) 2 LHA L-881 Series Circuit with Shorting Device Long Mount — 5900-211-01
- 3) 4 LHA L-880 Series Circuit without shorting device on long mount — 5900-201-11
- 4) 2 LHA L-881 Voltage Powered Standard Mount with Night Sentinel — 5900-210-20

Other options are available. Contact factory for more information.

## PHOTOMETRICS

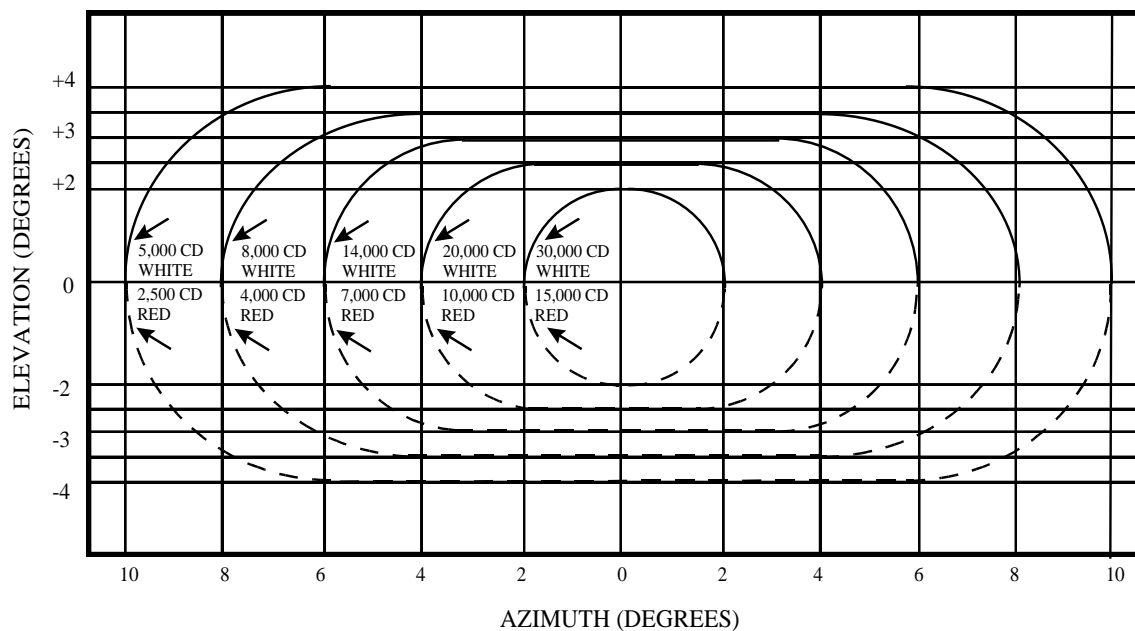

# Multi

ELECTRIC

The Quality Approach

## TYPICAL AIMING CRITERIA

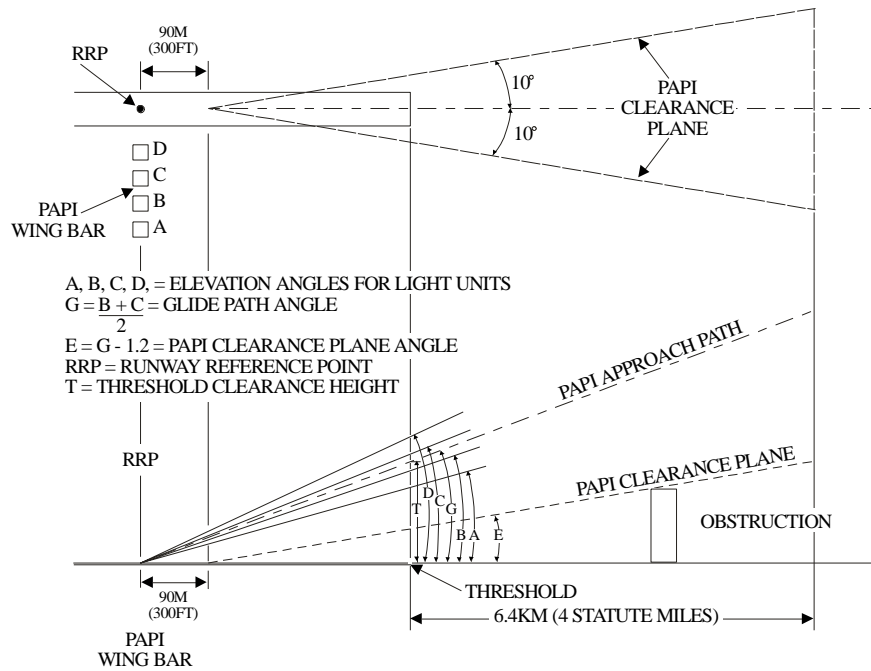

## TYPICAL LIGHT PATTERNS AS SEEN ON APPROACH

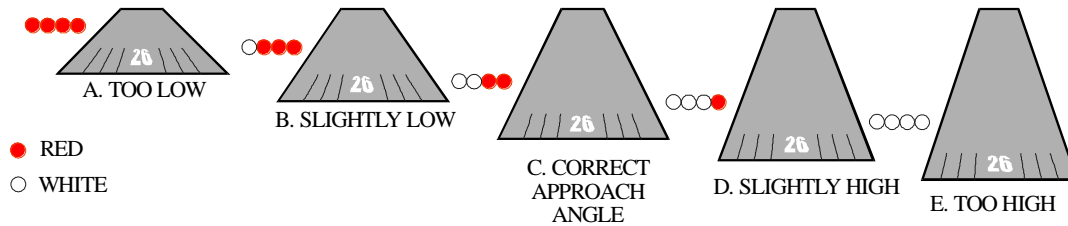

## PAPI PATTERNS AS SEEN FROM THE APPROACH ZONE

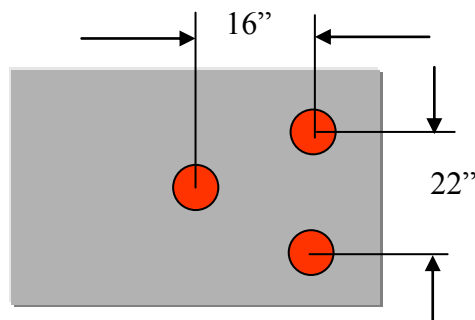

Standard Mounting Footprint 22in. W 16in. L

# Multi

ELECTRIC

*The Quality Approach*

## SPECIFICATIONS

### Electrical:

#### Style A Input Power

Voltage	Nominal 240 / 120 VAC 50-60Hz
Current	L-880 Less than 5.5 Amps L-881 Less than 3.0 Amps

#### Style B

6.6A – 315W per LHA Secondary Load  
6.6A or 20A 330W Maximum Regulator Load

### Optics:

Split Beam White over Red  
Transition of less than 3 min of arc.  
Optical Quality Glass Bi-Convex Lens Ground Red Filters

### Operating Temperature:

– 55°C to + 55°C (-67°F to + 168°F) Standard

## SPARE / RENEWAL PARTS

Part Number	Description	Part Number	Description
5903-100A	Lamp Housing Style A	9637-05	Lamp
5903-100B	Lamp Housing Style B	961-AT	Frangible Coupling – 2in
5903-100ICAO	Lamp Housing - ICAO	964-P	Frangible Coupling – 1.5in
5920-101	Power Control Unit	5556-19	Floor Flange
5900-77	Tilt Switch	5900-158	Leg Cap Assembly
5910-185	Master Control PCB - Style A	5903-185	Tilt Sensor and Lamp Control PCB - Style B
5900-186	Tilt Driver PCB – Style A	5903-196	Tilt Buffer – Style B
5920-200	Night Sentinel PCB – Style A	5900-166	Aiming Instrument with Carrying Case
5900-105	Red Filter	5900-09	Aiming Instrument
5910-10	Photocell	5910-06	Circuit Breaker
5900-150	Transformer	5910-04	Contactore